

# Voyager One

THORN

96636595 VOYAGER ONE CON ANT HP ECC WH

IP20 IK03    $T_a$ -10  
+40

## Voyager One

Slim IP20 LED emergency lighting luminaire; Luminaire for central emergency light supply, with circuit monitoring, without single monitoring of the luminaire; high performance (HP) version enables wider luminaire spacing and applications with higher illuminances (e.g. 5 lux, 1 footcandle); ; Cable length from emergency power source to last luminaire: 300 m; additional click-optics optimised for escape routes and open areas from higher mounting heights available; Click in legends for viewing from a maximum distance of 23 m and 30 m available to convert to escape sign luminaire; housing made of polycarbonate white; cover mode of transparent polycarbonate; Tool-less 'click' mounting; zero maintenance thanks to LED technology; service life of 50,000 h at constant luminous flux; Power supply: 220/240 V AC; Luminaire input power: 5.6 W; IP20; class of protection: SC2; Impact strength: IK03; Dimensions: 336 x 59 x 158 mm; weight: 0.61 kg



TLG\_VOYO\_F\_CONTUS.jpg

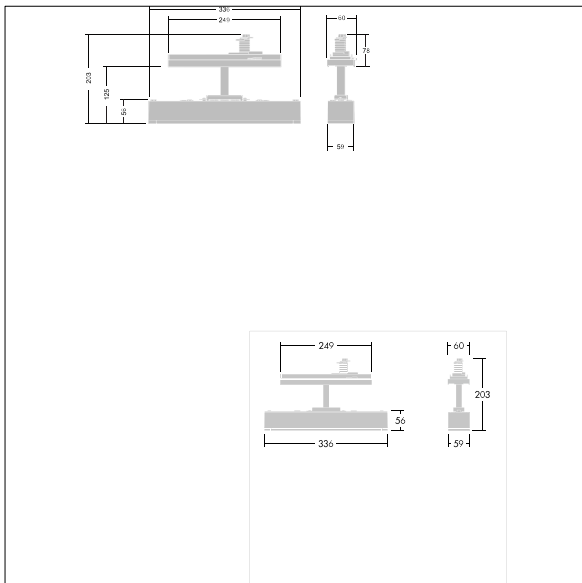

TLG\_VOYO\_M\_CONTUS.wmf

All values marked with an \* are rated values. Thorn uses tried and tested components from leading suppliers, however there may be isolated instances of technology-related failures of individual LEDs during the rated product lifetime. International standards set the tolerance in initial flux and connected load at  $\pm 10\%$ . Unless stated otherwise, the values apply to an ambient temperature of 25°C.

Thorn Lighting is constantly developing and improving its products. The right is reserved to change specifications without prior notification or public announcement.  
© Thorn Lighting

# Voyager One

96636595 VOYAGER ONE CON ANT HP ECC WH

THORN